

**DANGER**

Danger to life due to electric shock in case of accident or damage!

- Do not touch the high-voltage components.
- Do not cut high voltage cables (orange insulation/sheath).
- Disconnect the high voltage.

	Low voltage battery (12V)		High voltage battery		High voltage cables		Charging socket
	High voltage disconnect		High voltage components		High voltage disconnect (plug)		High voltage disconnect (cutting solution)

## Disconnect High-voltage\*

### A Unlock charging plug

Variant 1: Press the unlock key (A1) on the display or actuate the EMERGENCY STOP switch (A2).

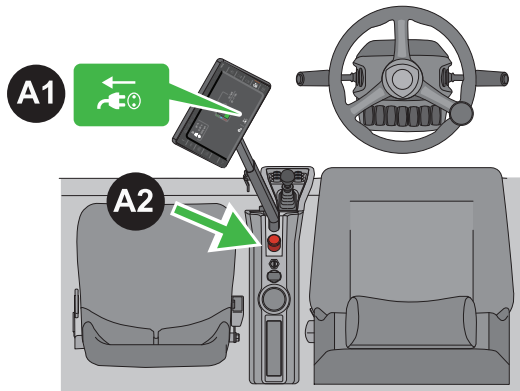

Variant 2: Open the cooler at the rear of the vehicle (B1). For emergency unlock, move the lever (B2) behind the plug socket to the left.

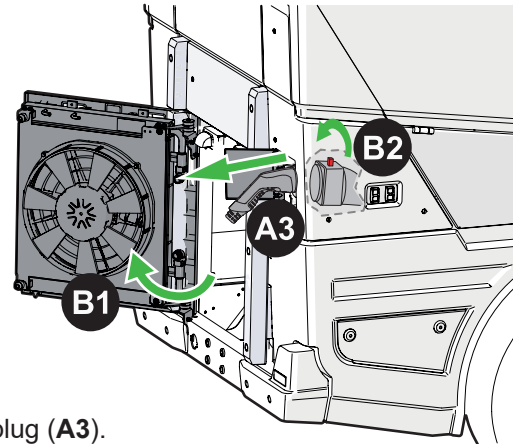

Remove charging plug (A3).

### C Remove the ignition key

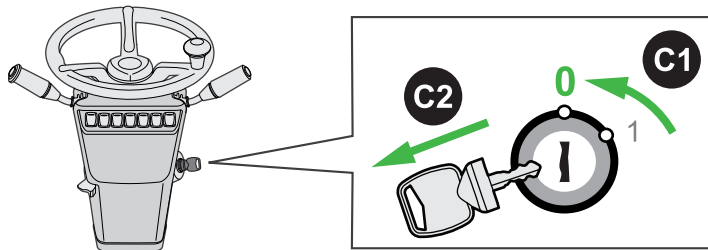

Disconnect high-voltage by switch off "ignition" (C1) of the vehicle. Remove the key (C2) and store it safely.

### D De-energise the high voltage control circuit

Variant 1: Open the cooler at the rear of the vehicle (D1) and disconnect the cable (D2).

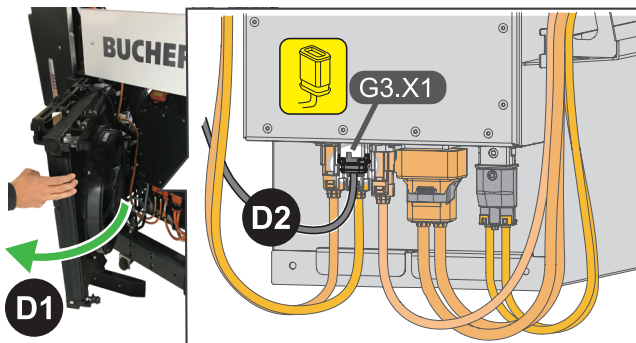

Variant 2: Cutting solution  
Cut through cable (E3) for the high voltage disconnect.

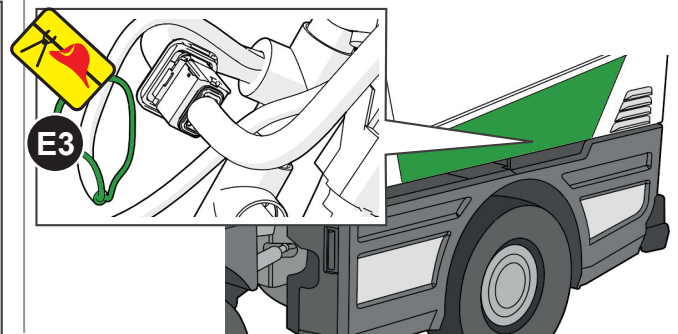

### F Deactivate high-voltage system

Open the cooler at the rear of the vehicle (F1). Pull out the latch of the right orange high-voltage disconnect (F2), pull the black handle upwards (F3) and pull out the high-voltage disconnect plug (F4). Repeat the same procedure for the left high-voltage disconnection point.

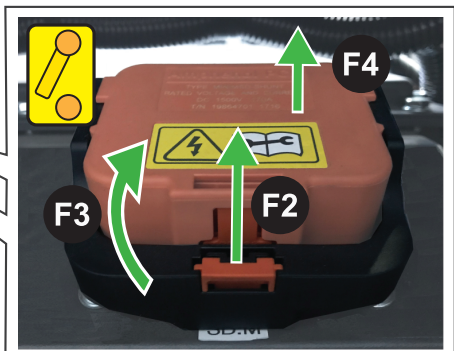
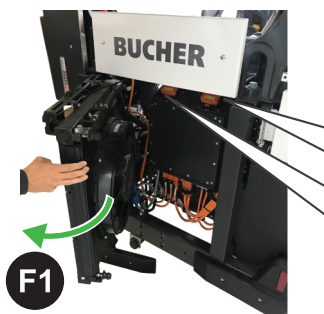

\* This description has been prepared solely for rescue teams.  
Disconnect high-voltage is not intended for repair shops and distributors.