

DANGER

Danger to life due to electric shock in case of accident or damage!

- Do not touch the high-voltage components.
- Do not cut high voltage cables (orange insulation/sheath).
- Disconnect the high voltage.

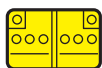

Low voltage battery (12V)



High voltage battery



High voltage cables

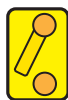

High voltage disconnect



High voltage components



High voltage disconnect

Disconnect High-voltage*

A Unlock charging plug

Press the unlock key (A1) on the display or actuate the EMERGENCY STOP switch (A2).

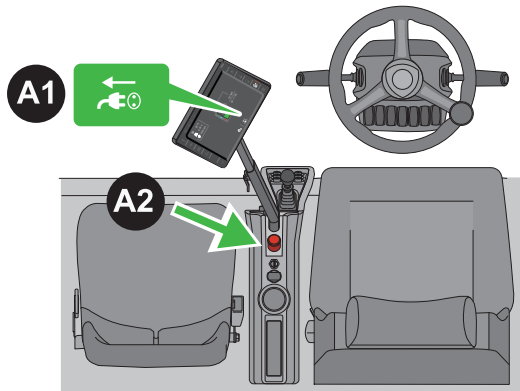

Variant 2: Open the right side flap on the hopper (B1). For emergency unlock, move the lever (B2) behind the plug socket to the right.

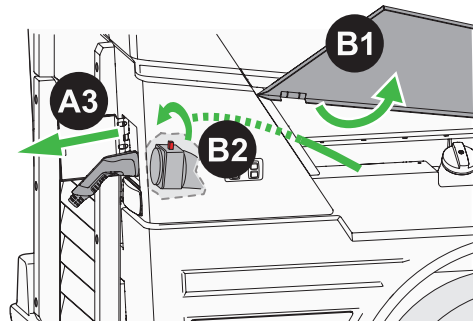

Remove charging plug (A3).

C Remove the ignition key

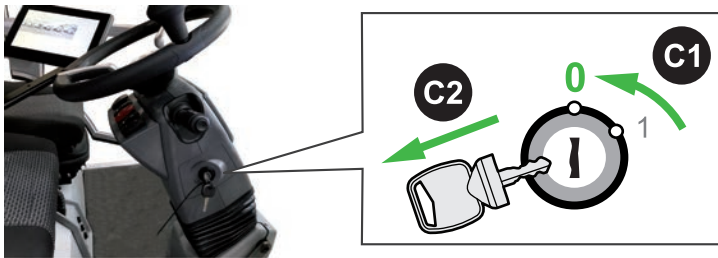

Disconnect high-voltage by switch off "ignition" (C1) of the vehicle. Remove the key (C2) and store it safely.

D High voltage disconnect

Open the cooler at the rear of the vehicle (D1) and disconnect the cable (D2).

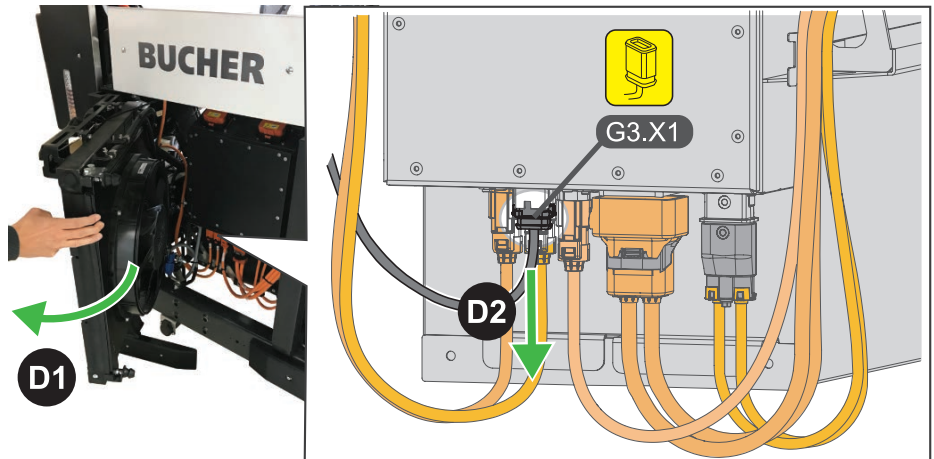

F Deactivate high-voltage system

Open the cooler at the rear of the vehicle (F1). Pull out the latch of the right orange high-voltage disconnect (F2), pull the black handle upwards (F3) and pull out the high-voltage disconnect plug (F4). Repeat the same procedure for the left high-voltage disconnection point.

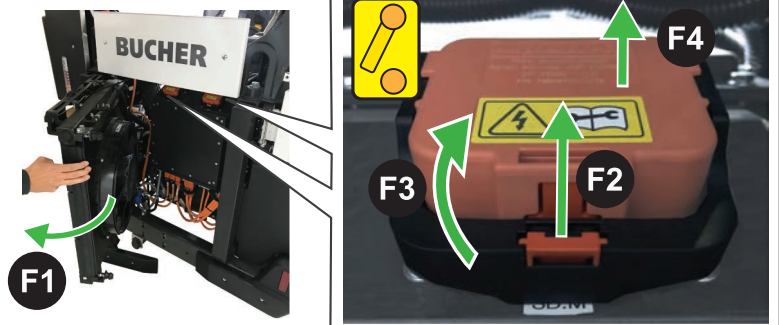

* This description has been prepared solely for rescue teams. Disconnect high-voltage is not intended for repair shops and distributors.