

Battery high voltage pack



High voltage component



High voltage power cable



High voltage device that disconnects high voltage



Cable cut



Charging socket



Battery low voltage



Ignition key

3. Disable direct hazards / safety regulations



The absence of engine noise does not mean that the vehicle is switched off. The vehicle can be re-started at any time until it is decommissioned. Do not cut or open any orange high-voltage cables or marked high-voltage components. Always wear suitable personal protective equipment (PPE).

Primary shut-off method: high-voltage

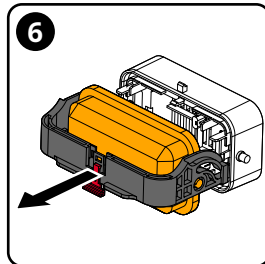
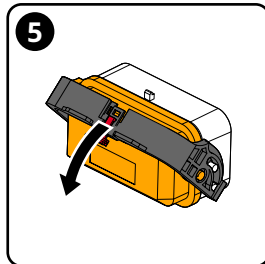
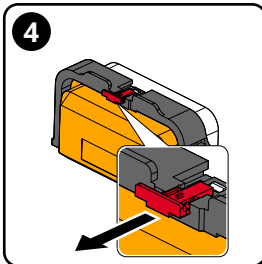
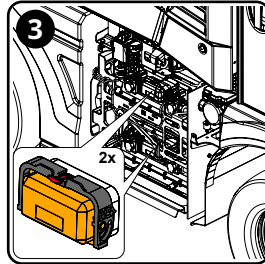
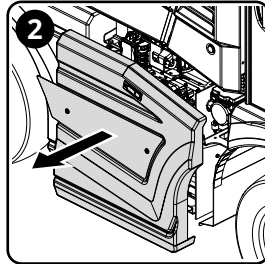
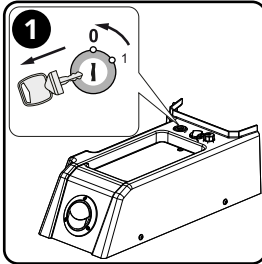
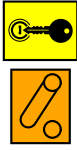

1. Remove the ignition key and put it aside in a safe place.
2. Remove the battery cover.
3. Remove both high-voltage isolating connectors.
4. Pull out the red tab.
5. Pull the handle down.
6. Pull out the high-voltage isolating connectors.

Alternative method for switching off the high voltage



The high-voltage cables from the high-voltage battery to the battery distribution unit remain live after the cable disconnection points have been severed.

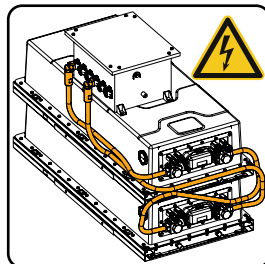
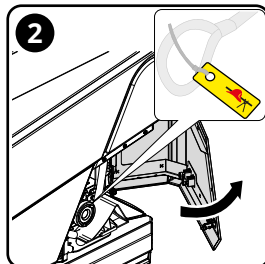
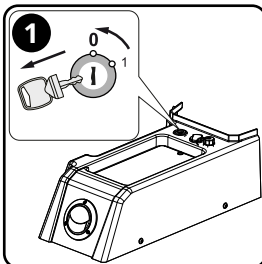
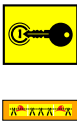

1. Remove the ignition key and put it aside in a safe place.
2. Open the rear flap and sever the cable disconnection points at both places.

Emergency unlock at the CCS2 charging socket



An electric arc can occur when the charging plug is pulled out under load. Never unplug the plug while charging is in progress. Switch off the charging station and abort the charging process. In the event of faults, or if conditions are unclear, do not operate the emergency unlock.

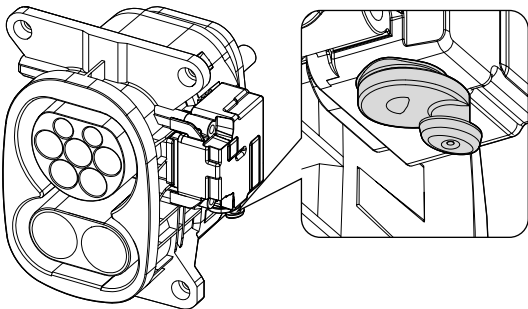

1. Operate the emergency unlock.
2. Disconnect the charging plug.